

SOIL PROFILES INC.

P.O. BOX 248
COVINGTON GA 30015

soilprofiles@gmail.com
PH 770-842-9895

J. SHANNON HUDGINS
GA DHR SOIL CLASSIFIER # 147

LEVEL: 3 (1=RECON, 2=PRELIMINARY, 3=HIGH INTENSITY, 4=SPECIAL STUDY)

DATE MAPPED: JULY 20, 2021

SCALE: 1"=100'

CLIENT: MARK MCCULLOUGH

PROJECT: MASSENGALE RD

ANY ALTERATIONS OR ADDITIONS MADE TO THIS REPORT WITHOUT THE WRITTEN APPROVAL OF SHANNON HUDGINS AND SOIL PROFILES, INC. VOID. THE REGULATION HEREON AND REMOVES ANY LIABILITY ON THE PART OF SOIL PROFILES, INC. ASSOCIATED WITH THE PREPARATION OF THIS REPORT. SOIL PROFILES, INC. DOES NOT DESIGN, INSTALL, MAINTAIN, OR PERFORM ON-SITE WASTE DISPOSAL SYSTEMS. SOIL RECOMMENDATIONS ARE BASED UPON SOILS AS MAPPED ON REPORT DATE. ALL WORK ALERTS OR EXCEEDS THE GEORGIA DEPARTMENT OF HUMAN RESOURCES (DHR) MINIMUM STANDARDS FOR SOIL EVALUATIONS FOR ON-SITE SEWAGE DISPOSAL SYSTEMS. YOUR LOCAL COUNTY ENVIRONMENTAL HEALTH DEPARTMENT MAY VIEW SOIL CONDITIONS DIFFERENTLY. IT HAS FULL AUTHORITY FOR PERMITTING ON-SITE WASTE DISPOSAL SYSTEMS IN YOUR AREA.

SOILS INTERPRETATION TABLE

SOIL SERIES AND CODE	SLOPE (%)	Depth to BEDROCK (inches)	Seasonal High WATER TABLE (inches)	Estimated PERC RATE @ Recommended Installation/Trench Depth (inches/minute)	Recommended DEPTH (inches)	COMMENTS
ALCOVY C	2-10%	>72	32	90-ATU	12-20-ATU	SEASONAL HIGH SATURATION
COLFAX F	2-10%	>72	24	NR	NR	SEASONAL HIGH SATURATION
HARD LABOR I C	2-10%	>72	36	90-ATU	12-24-ATU	SEASONAL HIGH SATURATION
HARD LABOR II P	2-10%	>72	50	75	12-26(12-36-ATU)	SEASONAL HIGH SATURATION
PACOLET A	2-10%	>72	>72	50	24-48	

NOTES

- AREAS WHICH FLOOD, HAVE FLOODING POTENTIAL, OR WHICH SERVE AS DRAINAGEWAYS SHOULD NOT BE USED.
- SURFACE AND SUBSURFACE DRAINAGE SHOULD BE DIVERTED AWAY FROM ABSORPTION FIELD LINES INSTALLED IN NEARLY LEVEL AREAS (0-5% SLOPE), AND FROM THOSE INSTALLED ON CONCAVE SLOPES.
- AREAS WITH SLOPE GREATER THAN 25% MAY BE USABLE FOR SEPTIC SYSTEMS IF SLOPE LIMITATIONS ARE OVERCOME BY SYSTEM DESIGN, OR BY SITE MODIFICATION (e.g. BENCHING).
- SAMPLE POINTS, SURFACE FEATURES, AND SURVEY CONTROL WERE LOCATED BY GPS (TRIMBLE MODEL PRO XRS).

SOIL SUITABILITY CODES

- A=THIS SOIL SERIES SHOULD HAVE ABILITY TO FUNCTION AS A SUITABLE ABSORPTION FIELD WITH PROPER DESIGN, INSTALLATION AND MAINTENANCE.
- G=DUE TO SHALLOW WATER TABLE CONDITIONS THIS SOIL IS SUITABLE FOR ALTERNATIVE ABSORPTION FIELDS ONLY.
- F=NORMALLY CONSIDERED UNSATISFACTORY FOR USE FOR ABSORPTION FIELDS.
- P=SUITABLE FOR SHALLOW CONVENTIONAL SYSTEM BUT REQUIRES ATU IF LINES ARE INSTALLED LESS THAN 24" FROM WATER TABLE INDICATORS.

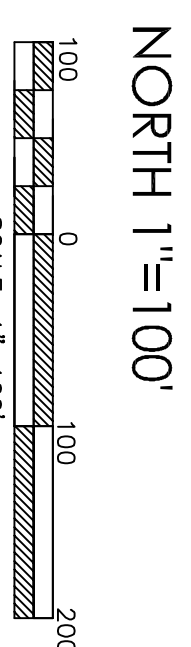
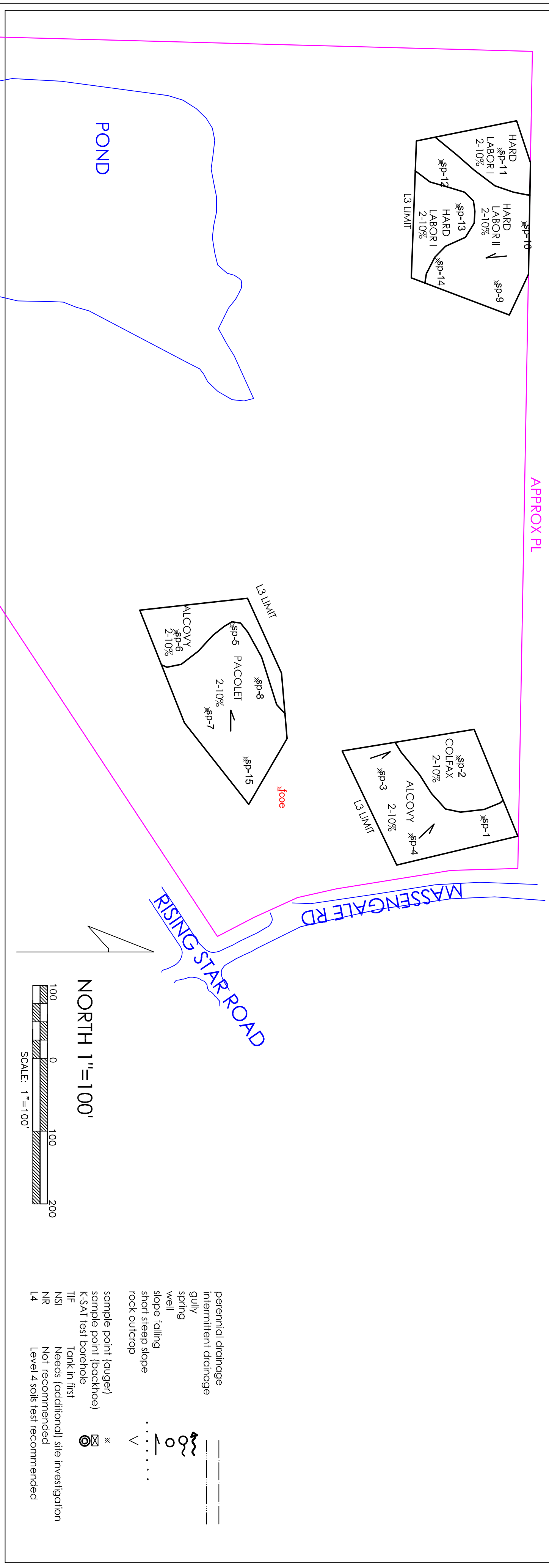

- perennial drainage
- intermittent drainage
- gully
- spring
- well
- slope falling
- short steep slope
- rock outcrop
- sample point (auger)
- sample point (backhoe)
- KSAT test borehole
- TIF
- NSI
- NR
- L4